

# CHESTER ELK'S LODGE 4th OF JULY ANNUAL ART/CRAFT SHOW

Hi Artists and Crafters

Its hard to believe that this will be the Lake Almanor Elks Lodge's six year hosting this great event which has been in existence since 1974. The show will began after Chester's 4th of July parade down main street. The 4th falls on a Thursday this year and will bring larger attendance because most visitors will extend their stay through the weekend. I would like to thank all the artists and crafters that attended our show in the past. I welcome new artists and crafters that join us this year. This show is one way we are able to financially maintain Lake Almanor Elk's Lodge 2626, letting the Elks do what they do best, help veterans and families that are experiencing difficult times in and outside Lake Almanor area, Scholarships, Christmas food baskets and gifts and warm cloths for children at this time of the year. The Elks thank you again.

For the first timers to the show here is some information to help you. Chester Park is located on Main Street (HWY 36). There are three ways to enter Chester Park. Parking lot off of Willow Way, Entrance #1. Entrance #2 is no longer available. Entrance #3 and #4 are accessed from Main Street (HWY 36) both of these have stairs that drop down into park.

Sites are assigned on first come basis for all new Artist/Crafters. Retuning Artists/Crafters, last years sites will only be held until May 1st. We try to make sure you're not next to an Artist/Crafter that has the same medium as you.

I am looking forward to seeing all the returning vendors and looking forward to meeting the new vendors to the great event.

Bill Mahaffey  
Lake Almanor Elk's 4th of July Show Booth Coordinator

# RULES

## (GOTTA HAVE'EM)

New Artist and Crafters only need to send photos of your work, no slides. A stamped self addressed long envelope for the return of your acceptance or rejection notification and photos.

All products sold must be handmade buy the exhibitor

Exhibitor will staff their booth for the duration of the event

Exhibitor will be responsible for making sure that their area be kept clean

You must sell your own product(s) no representatives

Entry fees pay for all expenses therefore no refunds

When sharing booths each artist/crafter shall have a separate application and resale permit

Exhibitor will indicate on the application all items to be sold. Include extra sheet of paper if necessary

Vehicles are not normally allowed in park for safety but exceptions are allow with approval.

All artist/crafter must check in before setting up

No playing music during event hours unless that is your product. Keep music level low

Non profit booths will be manned for the duration of the event.

Bill Mahaffey  
Lake Almanor Elks 4th of July Show Booth Coordinator

# MAP OF CHESTER PARK WITH SPACE SITES

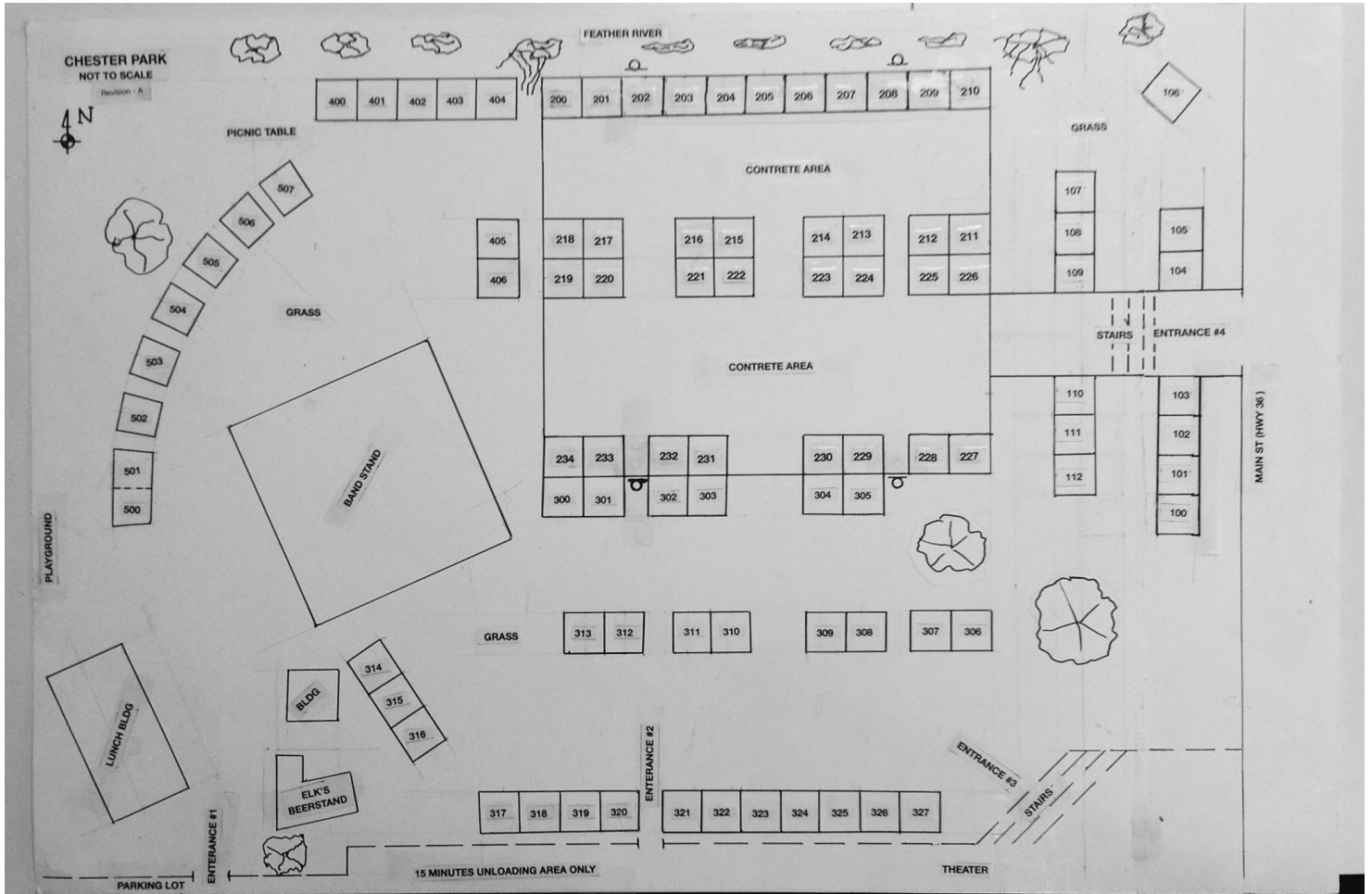

NOT TO SCALE  
Revision A

# ELK's 50th ANNUAL JULY 4th CHESTER ART/CRAFT SHOW

**PLACE:** Chester Park along the Feather River in downtown Chester

**TIME:** July 4<sup>th</sup> – 10:00 AM to 3:00 PM

**APPLICANTS:** All Artists & Craft persons welcome with California Resale Number

A 10x10 spaces will be pre-assigned to ensure show balance. We cannot guarantee grass, concrete, **SHADE or Mother Nature's Mood.** Artists/crafters should plan accordingly and provide their own shade and a display that will be equally suitable for lawn or concrete. Artists/crafters should also include weights to hold down their canopy due to wind.

**SETUP:**

Set up will be on July 3<sup>rd</sup> between **4:00 PM to 8:00 PM** at your own risk or July 4<sup>th</sup> morning from **6:00 AM to 9:00 AM.** Please wait until **3:00 PM** before starting your tear down your display regardless **of sales** or **lack of sales.** Thank You  
**The Lake Almanor Elks Lodge is not responsible for any damages during transporting items.**

**ARTWORK/CRAFTS:**

All artworks and crafts must be original and of good quality. No commercially or mass produced objects or imports are acceptable.

**REGISTRATION:**

Entries must be received no later than July 3rd \* Please mail the following to:

LAKE ALMANOR ELKS LODGE  
P.O. BOX 1329 CHESTER, CA 96020

1. Completed Application
2. 3-5 color photos of artworks/crafts (*returning vendors are exempt*) NO SLIDES PLEASE. A STAMPED SELF ADDRESSED, LONG ENVELOPE FOR THE RETURN OF YOUR ACCEPTANCE OR REJECTION NOTIFICATION AND PHOTOS.
3. \$100.00\*\* fee for your 10x10 space payable to Lake Almanor Elks #2626
4. Notification of acceptance or non-acceptance will be mailed or emailed to you. Once accepted into the show, the fee is non-refundable.

**ARTIST'S/CRAFTER'S**

Terms of sales, sales tax, delivery and insurance are the responsibility of the individual. The artist/crafter **MUST** be present to **SELL OWN WORK**, we have been forced to deny showings because of this.

**RESPONSIBILITY:**

THE LAKE ALMANOR ELKS LODGE IS NOT RESPONSIBLE FOR ANY LOSS or DAMAGES

\* Returning vendors last years space will only be held until **May 1st.**

\*\* We must have the \$100.00 to lock in your space

\*\*\*\*\*

**PREVIOUS PARTICIPATION IN THIS CRAFT SHOW:** (Check Yes or No) YES \_\_\_\_\_ NO \_\_\_\_\_

**NAME OF ARTIST/CRAFTER:** \_\_\_\_\_

**RESALE NUMBER:** \_\_\_\_\_

**BUSINESS NAME:** \_\_\_\_\_

**MAILING ADDRESS:** \_\_\_\_\_

**EMAIL ADDRESS:** \_\_\_\_\_

**CITY:** \_\_\_\_\_ **STATE:** \_\_\_\_\_ **ZIP:** \_\_\_\_\_ **CONTACT PHONE:** \_\_\_\_\_

**MEDIUM:** Pottery, Painting, Photography, Jewelry, Stained Glass, Wood, Fabric, Etc.: \_\_\_\_\_

**DESCRIPTION OF ARTWORKS/CRAFTS (BE EXPLICIT):**

\_\_\_\_\_  
\_\_\_\_\_

**I HAVE READ THE ABOVE AND AGREE TO THE FOLLOWING:**

**SIGNATURE** \_\_\_\_\_ **DATE:** \_\_\_\_\_